

Standalone V5 license installation and activation

1/ Installation of Phase Manager

Run the setup and choose the installation language:

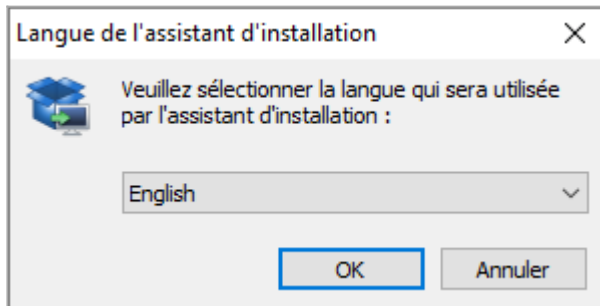

Skip the welcome screen by clicking on **Next** :



Accept the license agreement then click on **Next** :

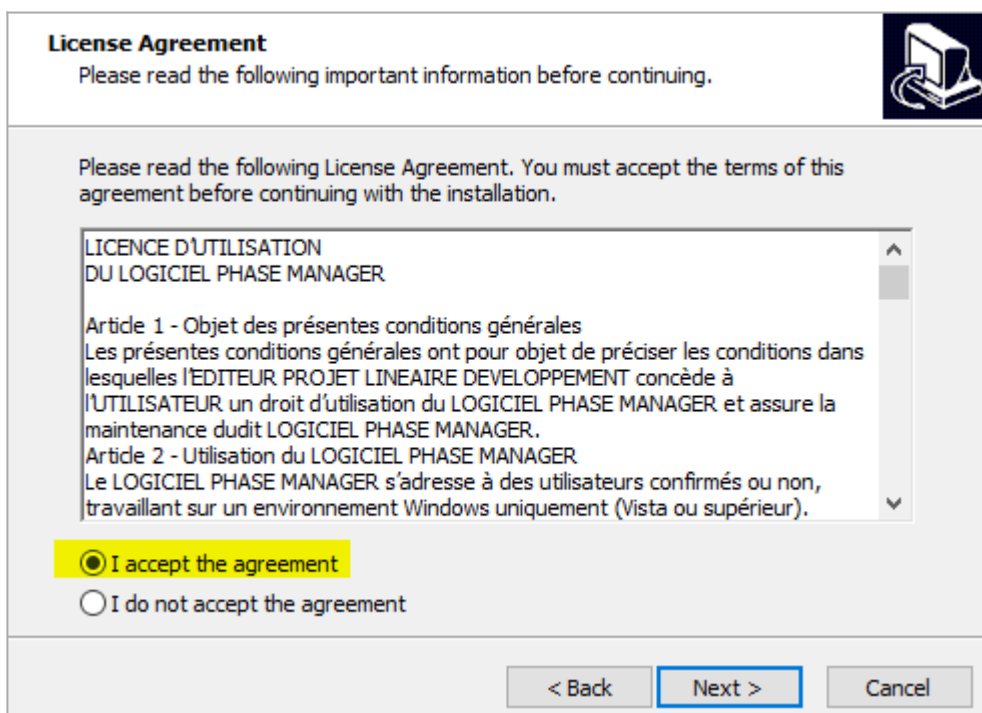

Destination location : we **recommend you keep the default path**:



Choose '**Single user installation**'

Select Components 

Which components should be installed?

Select the components you want to install; clear the components you do not want to install. Click Next when you are ready to continue.

Single user installation 

Validate the Start Menu Folder screen by clicking on **Next** :

Select Start Menu Folder 

Where should Setup place the program's shortcuts?

 Setup will create the program's shortcuts in the following Start Menu folder.

To continue, click Next. If you would like to select a different folder, click Browse.

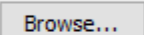
Projet Lineaire 

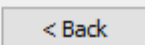
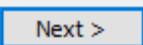
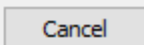
Choose and validate the icons creation screen by clicking **Next** :

Select the additional tasks you would like Setup to perform while installing Phase Manager4 4.0, then click Next.

Additional icons:

Create a desktop icon

Create a Quick Launch icon

On the following screen click on **Install** then once installation is complete, click on **Finish**

2/ Standalone license configuration

Once Phase Manager 5 is installed, double-click on its icon to launch it.
At first launch, the license configurator will display:

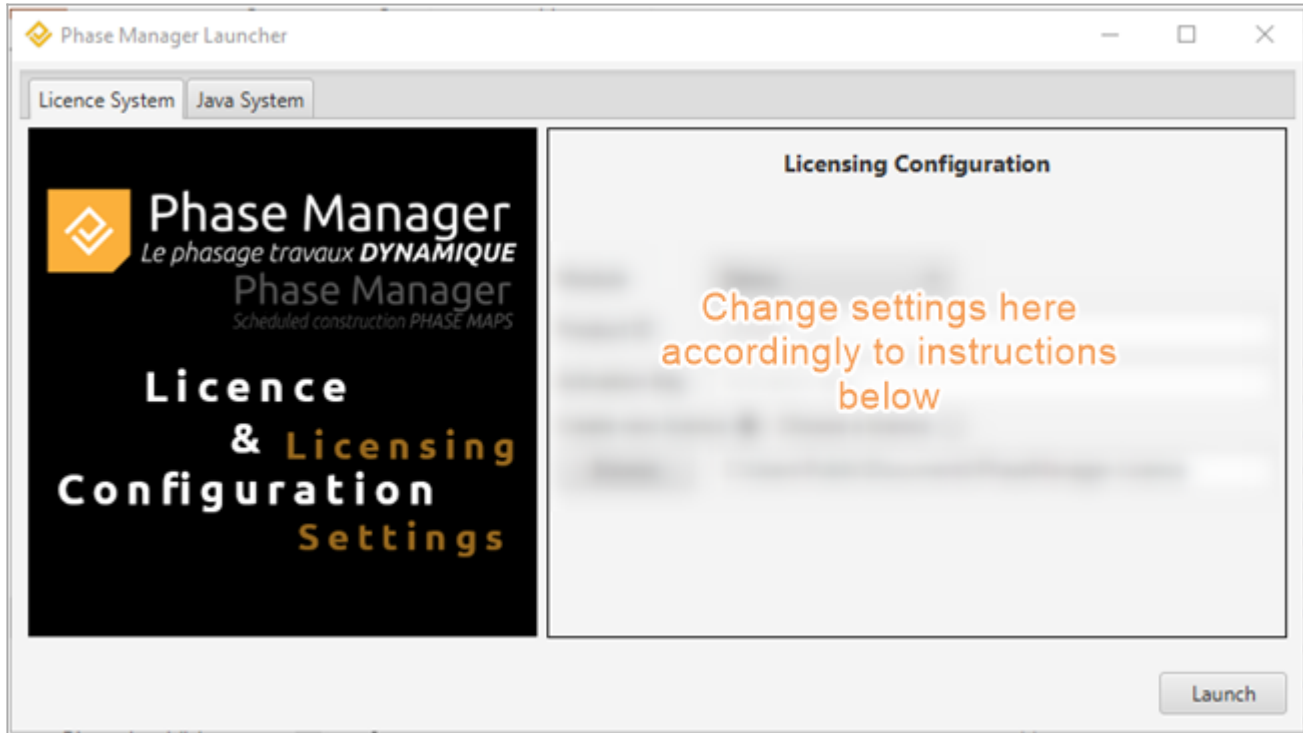

To activate your license, you will need to fill in the following fields:

Module

Choose **Monoposte** :



Product ID

Fill in the Product ID that's been sent to you by Projet Linéaire:

- licence pattern : LPMM-**00NNN0500abcDEF** (NNN is the number of your license, and 5 the version)
- **only paste the right part of your Product-ID, after the '-' :**

Module	Monoposte	
Product ID	LPMM	00NNN0400abcDEF

Activation key

Fill in the Serial number sent to you by Projet Linéaire.

- pattern : VccQX-37eJG-AZlce-EYk7O-temCP-8DRFu

Module	Monoposte	
Product ID	LPMM	00NNN0400abcDEF
Activation...	VccQX-37eJG-AZlce-EYk7O-temCP-8DRFu	

Licence

Choose "Create new licence" : Create new licence Choose a licence

By clicking on the button you can choose the location of the license file that will be created by Phase Manager : **we recommend to leave the default value:**

Module	Monoposte	
Product ID	LPMM	00NNN0400abcDEF
Activation...	VccQX-37eJG-AZlce-EYk7O-temCP-8DRFu	
Create new licence	<input checked="" type="radio"/> <input type="radio"/> Choose a licence	
<input type="button" value="Browse"/>	C:\Users\Public\Documents\PhaseManager-Licence	

3/ License activation

Click now on the button to activate your licence.

Beware : an Internet connection is mandatory to activate the license !

To activate the license, switch to English then choose the option below, and click on **Next** :

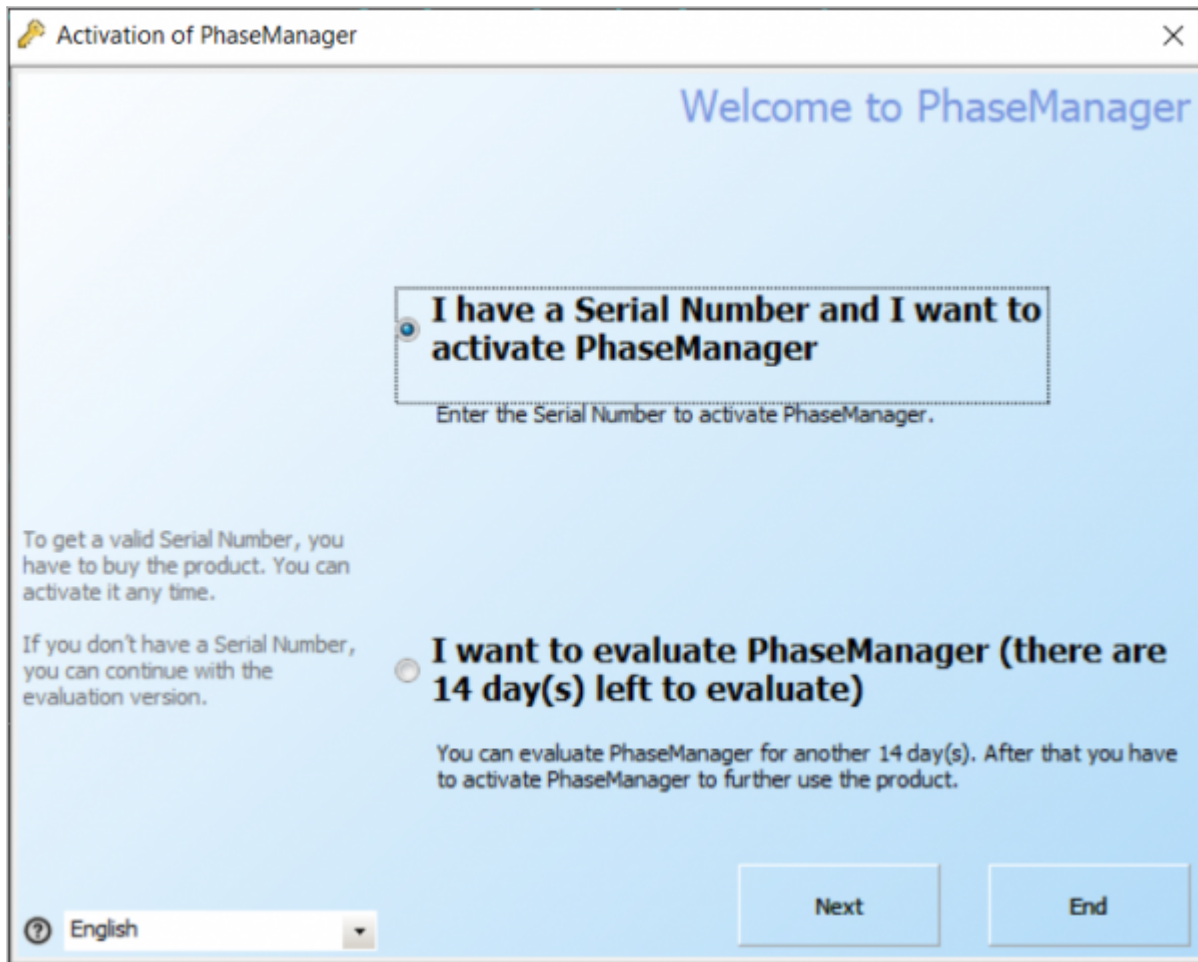

- Fill in all required data then click on Next:
- **The Serial number is the Activation Key that's been used at step 2 in the license configurator**

Activation of PhaseManager

Please enter the activation data

Please enter all required information for the activation process.

Enter Serial Number

JB F8

[Where do you find your Serial Number?](#)

Enter Name / Company / Organisation

SSA/PL

Enter your E-mail Address

ssauteur@projetlineaire.com

required

English

Back Next End

- Check that you ARE connected to INTERNET then click on Next:

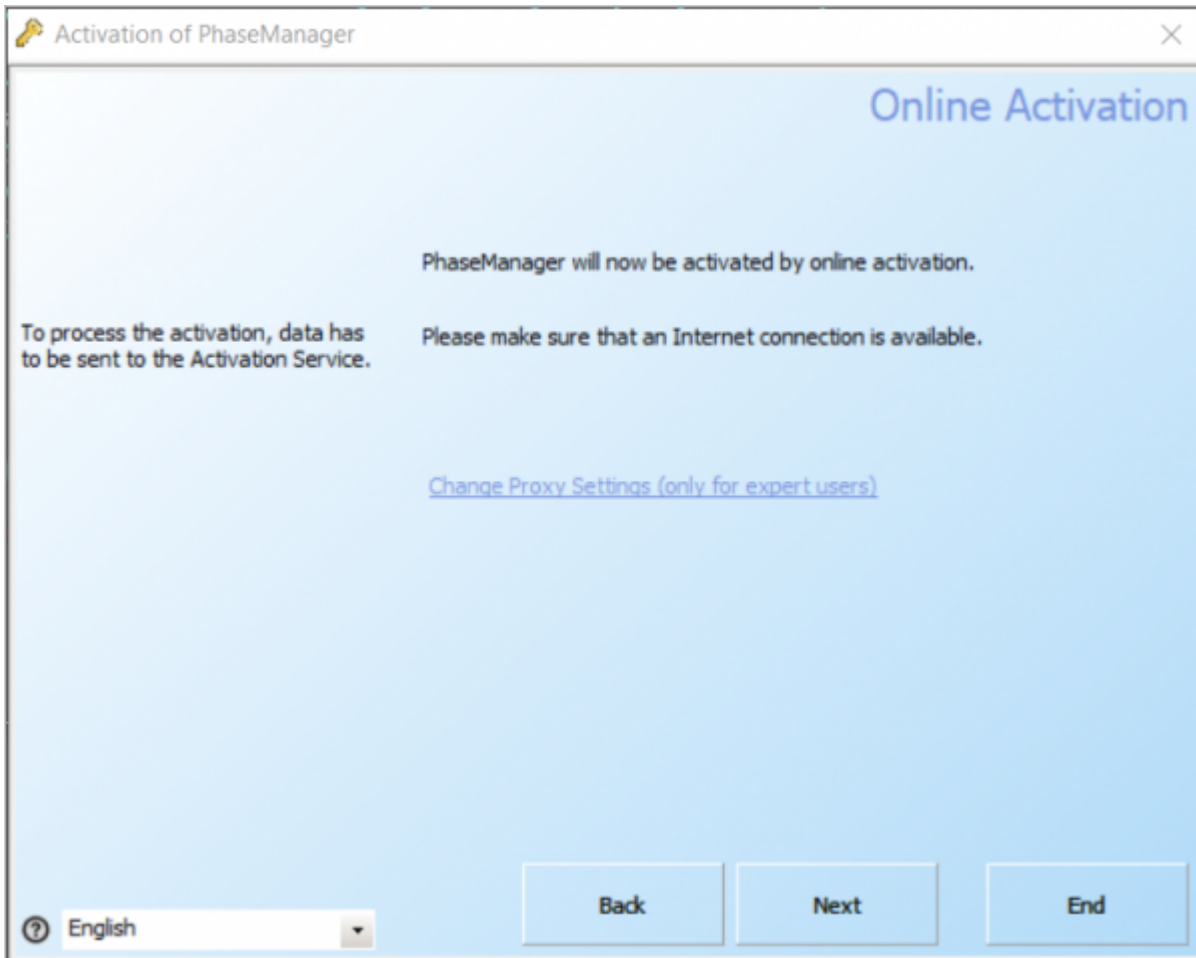

- If the following message is displayed, that means that Phase Manager did activate right. Click on Next to run Phase Manager:

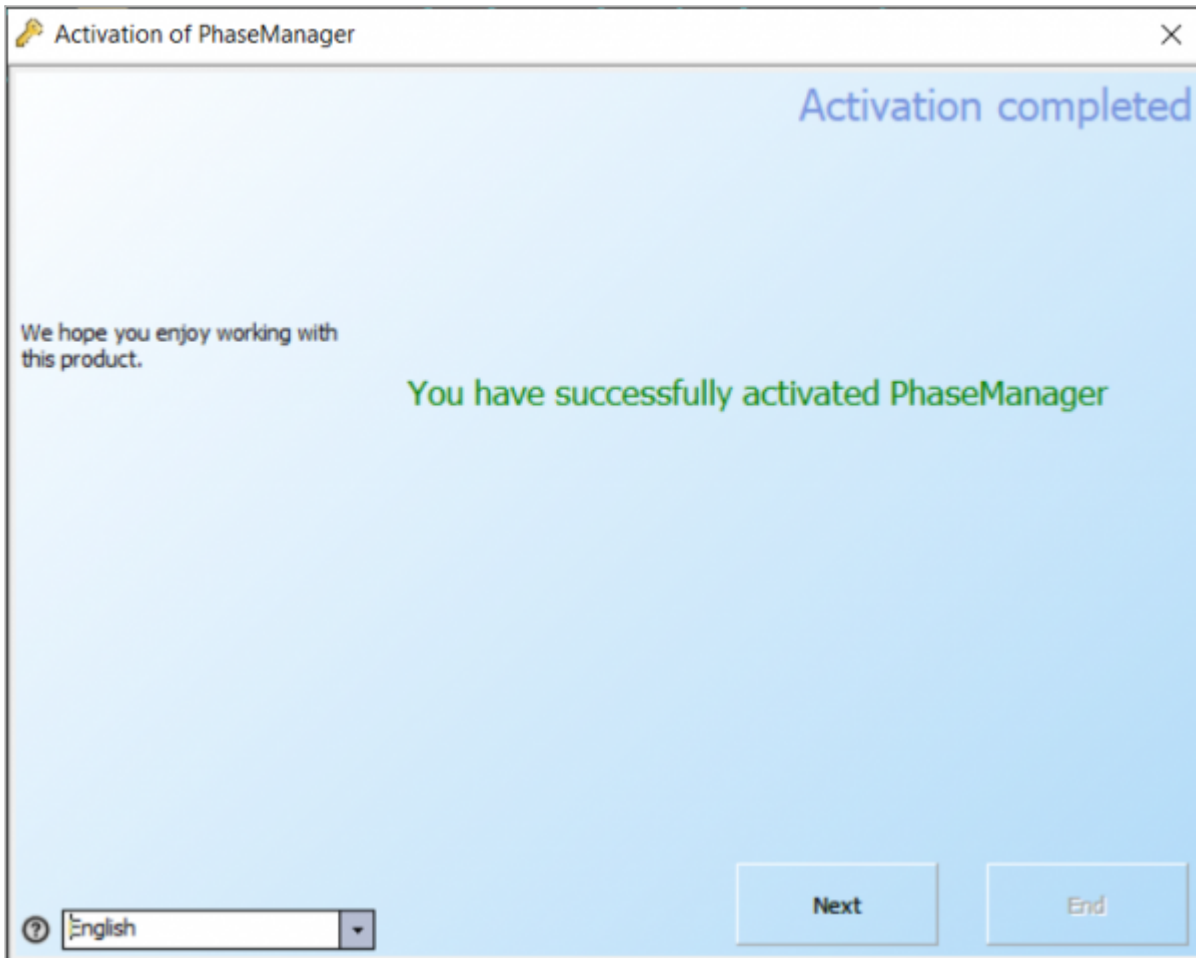

- If you need to, feel free to contact our customer support at support@projetlineaire.com